

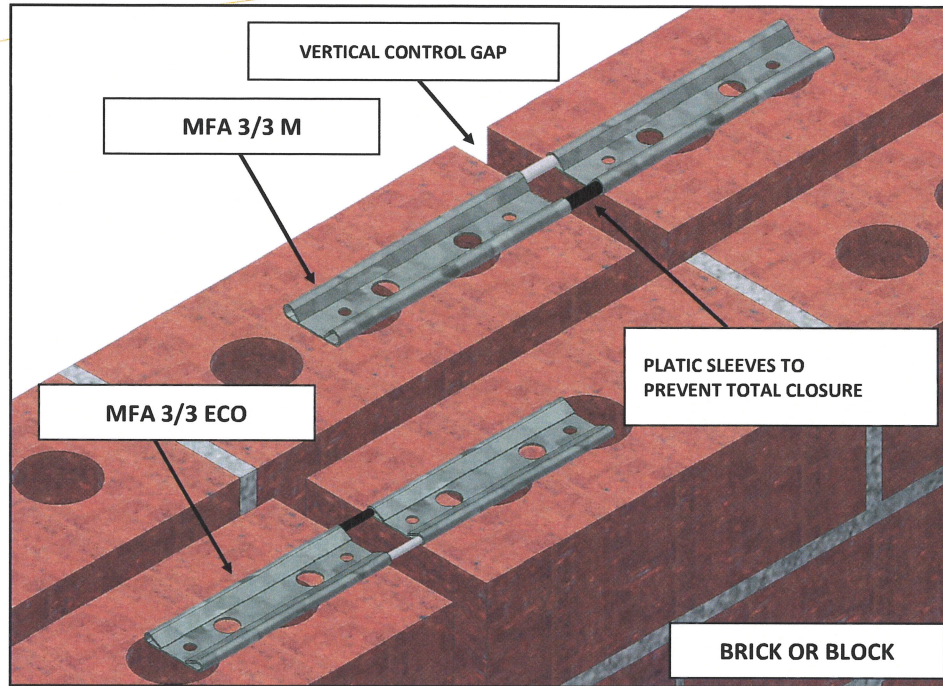

Brunswick Sales
Construction Manufacturer & Supplier

MASONRY FLEXIBLE ANCHORS

25 Park Drive, Dandenong, Vic 3175
Phone (03) 9768 3111
Email info@brunswicksales.com.au
www.brunswicksales.com.au



VERTICAL CONTROL JOINT

SKU: MFA 3/3 M and MFA 3/3 ECO

Vertical control joints are usually 15 - 20mm in width and are provided in masonry walls to accommodate for horizontal movements. They are not normally provided in base brickwork less than 600mm high or on the internal leaves of clay brick cavity walls of small buildings.

The **MFA 3/3** is without doubt the most recognised product within the Masonry Flexible Anchor range of products since the inception of the product in 1968.

Two units now exist for slightly different applications.

The **MFA 3/3M** is the traditional, original expansion tie that is used in many commercial brick and block projects. This product is available in a Galv steel finish and of course in Grade 316 Stainless steel.

This product has been a proven performer in the commercial construction industry in allowing for expansion and contraction with masonry applications. Technical data available upon request.

The newer product is known as the **MFA 3/3 Eco**. This slightly smaller unit in size has been designed more for residential and domestic use. The application and use of the product remains the same, providing for expansion and contraction within masonry applications as the larger 3/3M, however, aligns itself to the residential housing market. The **MFA 3/3 Eco** is available in a Galv finish only.

